

#4122

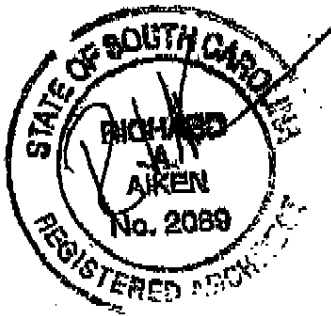

NOTE:
 Capacity shown here is for general use
 and does not include any other
 equipment likely to be used in the
 room or the building.

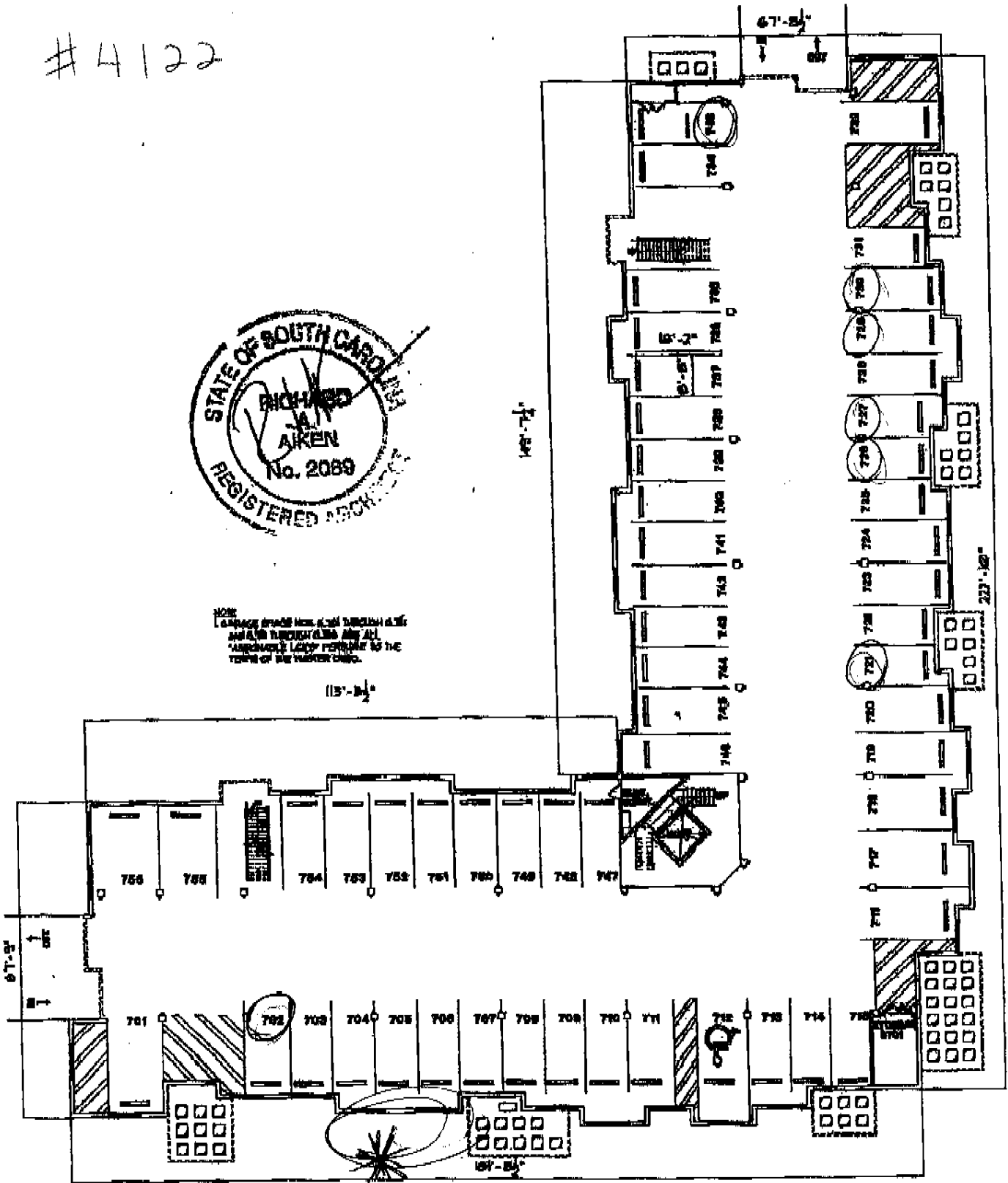

BUILDING 1000 PARKING PLAN

SEPTEMBER 26, 2006

**REGATTA ON
 JAMES ISLAND HPR**

HARPER AIKEN PARTNERS, INC.

EXHIBIT "B" TO FIRST AMENDMENT TO MASTER DEED PAGE 20

Plenty of parking outside.